

Images in exhibit are meant to provide a visual representation of the general scope of the improvements subject to this Agreement. The amount maximums, processes and specific funds used for reimbursement shall be subject to the language of this Agreement.

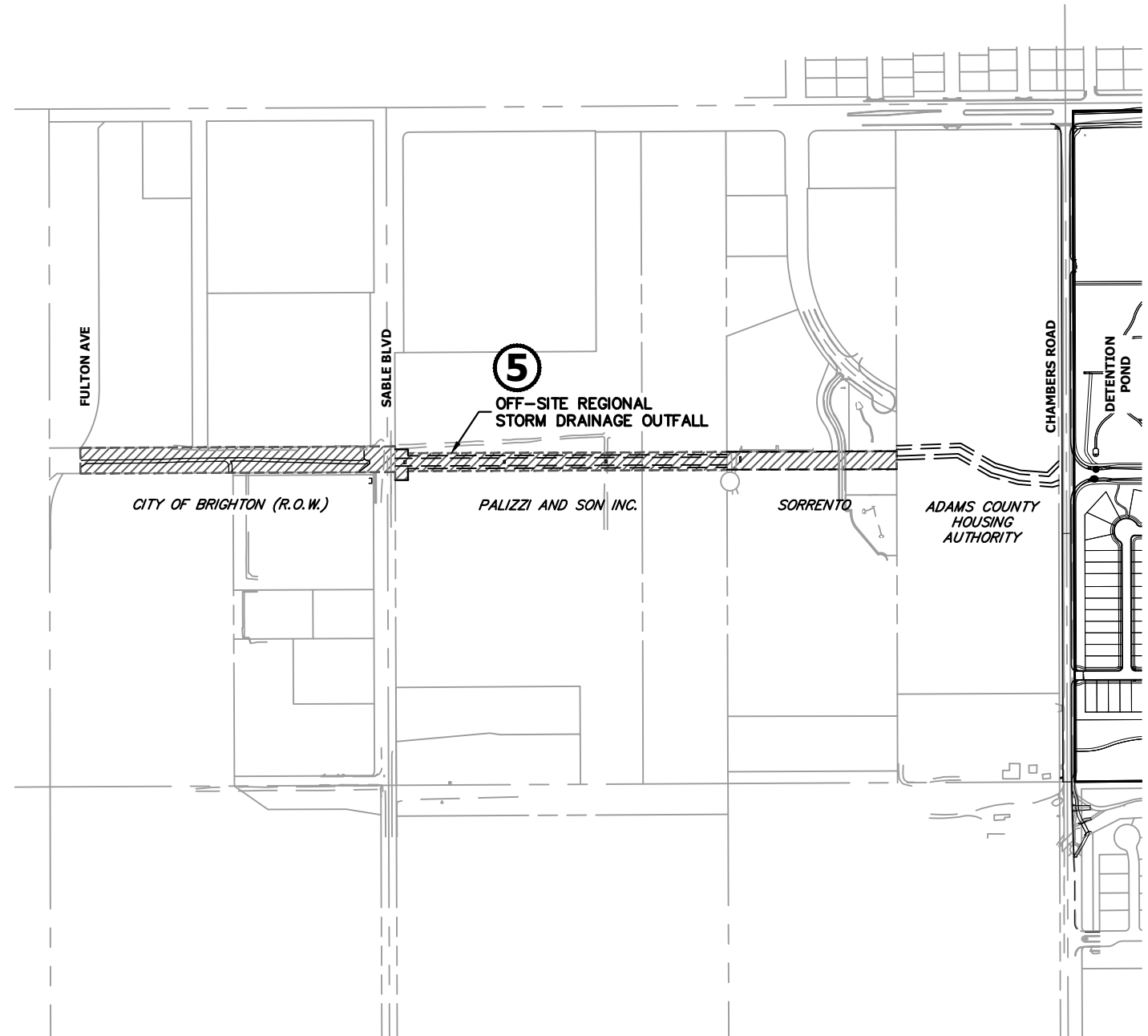

600 300 0 600

ORIGINAL SCALE: 1" = 600'

EXHIBIT A  
REIMBURSEMENT AGREEMENT  
BROMLEY FARMS FILING NO. 1  
JOB NO. 16107.01  
MAY 23, 2025  
SHEET 1 OF 2



**J·R ENGINEERING**

A Westrian Company

Centennial 303-740-9393 • Colorado Springs 719-593-2593  
Fort Collins 970-491-9888 • [www.jrengineering.com](http://www.jrengineering.com)

Images in exhibit are meant to provide a visual representation of the general scope of the improvements subject to this Agreement. The amount maximums, processes and specific funds used for reimbursement shall be subject to the language of this Agreement.

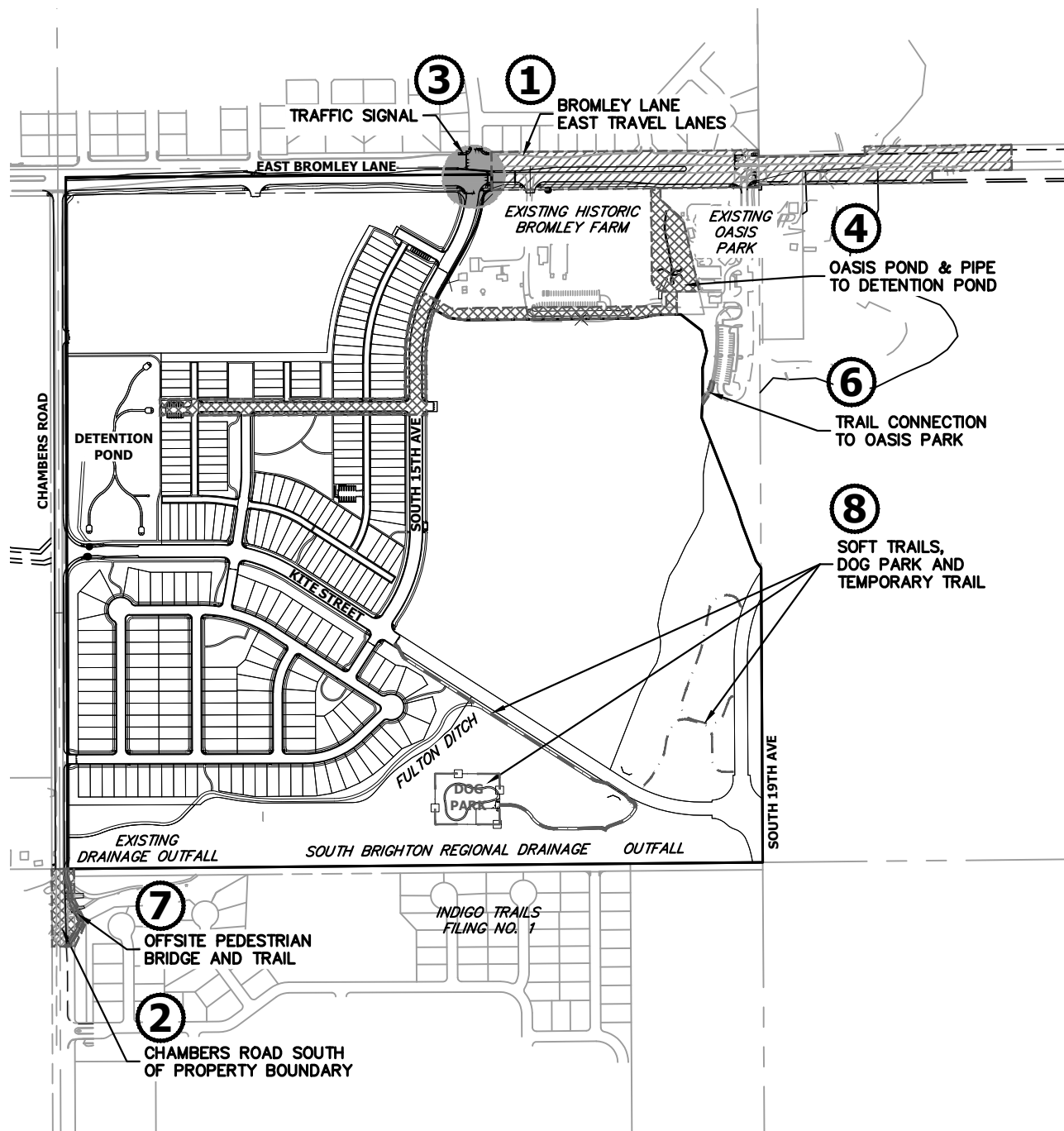

600 300 0 600

ORIGINAL SCALE: 1" = 600'

EXHIBIT A  
REIMBURSEMENT AGREEMENT  
BROMLEY FARMS FILING NO. 1  
JOB NO. 16107.01  
MAY 23, 2025  
SHEET 2 OF 2



**J-R ENGINEERING**

A Westrian Company

Centennial 303-740-9393 • Colorado Springs 719-593-2593  
Fort Collins 970-491-9888 • [www.jrengineering.com](http://www.jrengineering.com)